

# Proposed Site Plan

## Wilmot Road

### The Proposal:

The proposal is for 4x 2 bed homes and 1x 1 bed bungalow with 9 car parking spaces in a courtyard. The main changes to the plans are that terraces are joined together to produce one stepped terrace and a communal bin store is provided which was required by the refuse team. Additionally, We have removed one house from the western edge in order to avoid drainage runs and reduce overlooking neighbouring properties and 1 bedroom window to each of the first 2 homes include obscured glazing to eliminate overlooking to the site.

We had 23 responses to our second consultation on the website as well as other discussions with local residents. The main points made and how we have taken these on board are shown in the table to the right.

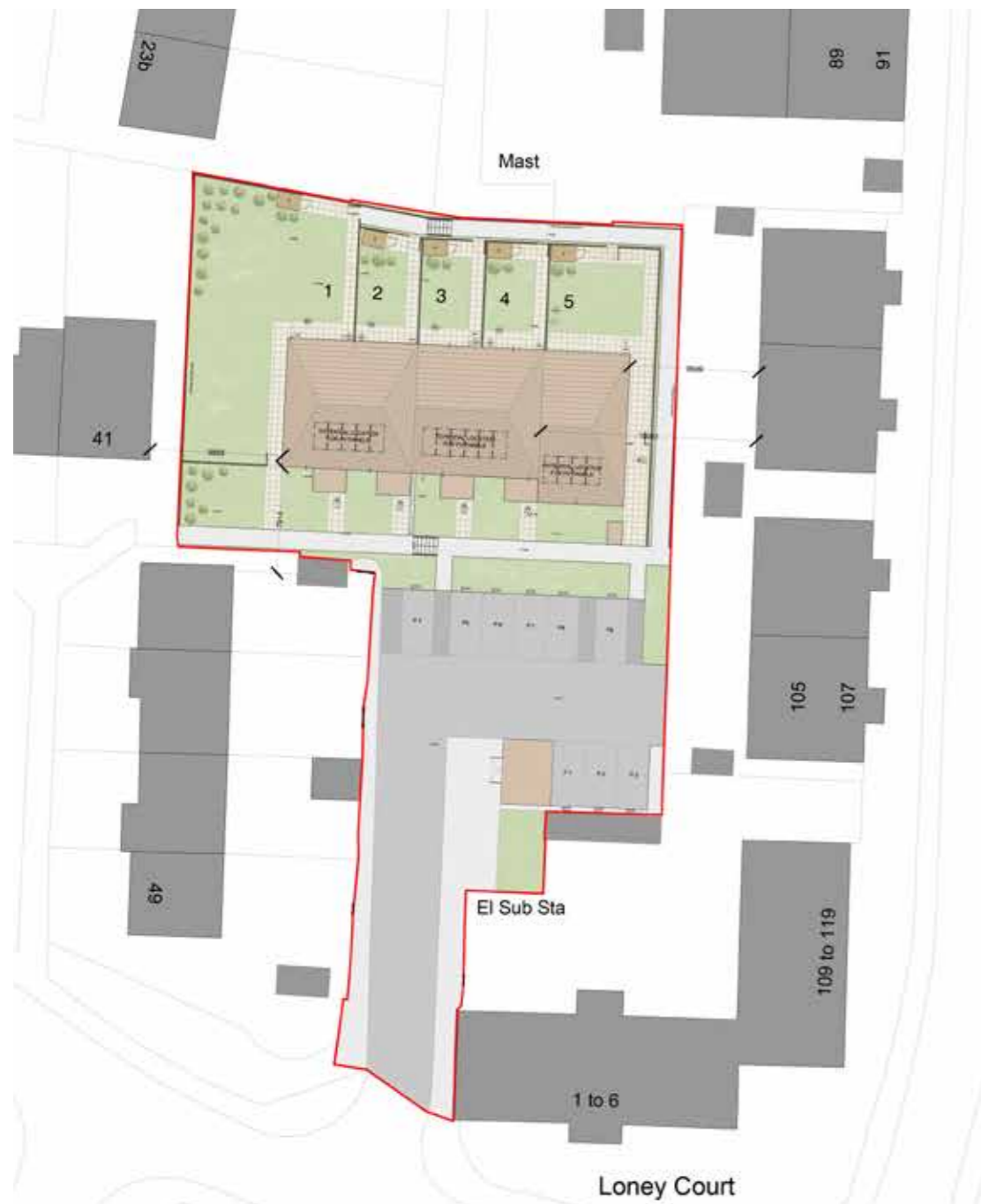

Examples of landscapes



### You said:

### We did:

<ul style="list-style-type: none"> <li>• Car parking is a problem in the area and this development will make things worse.</li> </ul>	<ul style="list-style-type: none"> <li>• We have maximised the number of spaces on site rather than providing more green space and the number is over that required by WSCC so there will be spaces for existing residents. We have had to provide a bin store which has taken up additional space.</li> </ul>
<ul style="list-style-type: none"> <li>• New housing will have an impact on privacy and sunlight for neighbours.</li> </ul>	<ul style="list-style-type: none"> <li>• We have amended the plans to decrease impact on neighbours. This includes omitting the house at the western end of the terrace, closing the gap between the two terraces, and providing a hipped roof to the bungalow.</li> </ul>
<ul style="list-style-type: none"> <li>• The new homes should fit in with the area and use materials similar to existing housing.</li> </ul>	<ul style="list-style-type: none"> <li>• We propose traditional materials with red brick elevations and grey slate or tiled roofs.</li> </ul>



# Elevations

## Wilmot Road

### Elevations



Front, South facing elevations



Rear, North facing elevations



Side, East facing elevations



Side, West facing elevations

### Materials:

The materials proposed at Wilmot Road include grey roof tiles and varied multistock red brick to blend with neighbouring properties, whilst a projecting horizontal brick course adds textural contrast that defines each residence. The entrance canopies in front of each property also hide refuse areas and will be constructed from red brick.



Brickwork  
Plane

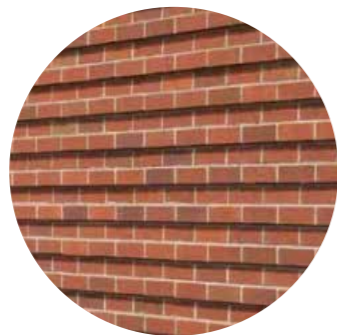

Textured  
brickwork



Window frames  
Grey



Grey roof tiles