

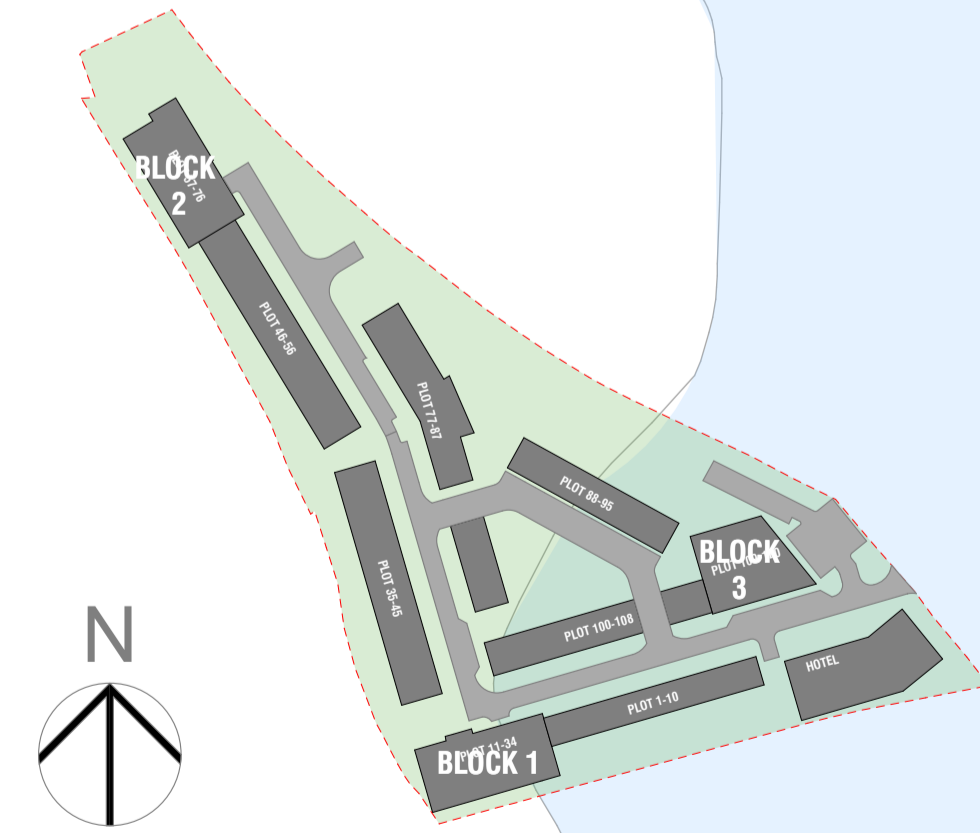

NOTE:
 Planning permission was granted for the Adur Tidal Walls scheme after the outline approval for this site was granted. However, the precise and final position of the Walls is likely to require adjustment and minor realignments as the works are implemented. For these reasons the river frontage application site boundary and tidal wall boundary are currently not in the same position on the plans but will coincide and share a common boundary once the Tidal Wall are constructed.

DRAWING KEY



NOTES

PLANNING



Scale @ A1: 1:500
 Date: 04 Jun 2018

TITLE
 ROPETACKLE, SHOREHAM
 PROPOSED ROOF PLAN

Drawing No: 13.152.104



Revision: []
 HGP Architects Ltd
 Copyright Reserved.
 Check dims. on site.

REVISIONS