

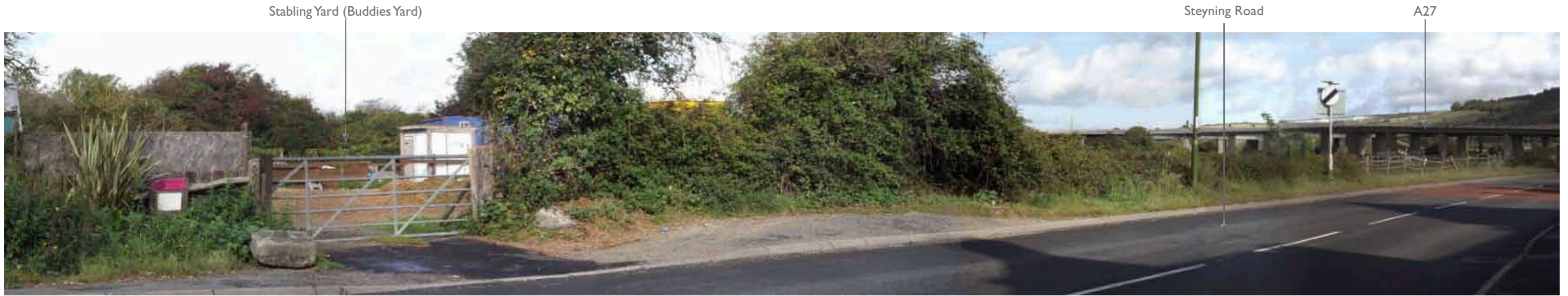



Viewpoint 1: View south from Downs Link (Sustrans Regional Cycle Route 79) Coastal Path F



Viewpoint 2: View northwards towards the Site from the entrance to Valentine Close, Steyning Road F



Viewpoint 3: View from the corner of Old Shoreham Bridge and Footpath 2049

F



Viewpoint 4: View from Old Shoreham Bridge

F

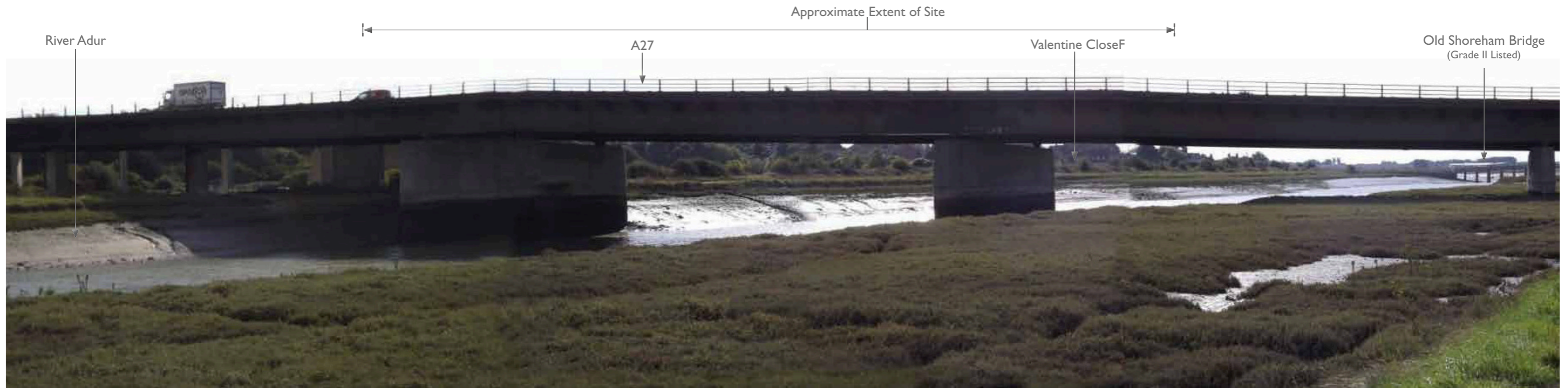

Viewpoint 5: View southwards from Footpath 2049, north of the A27F

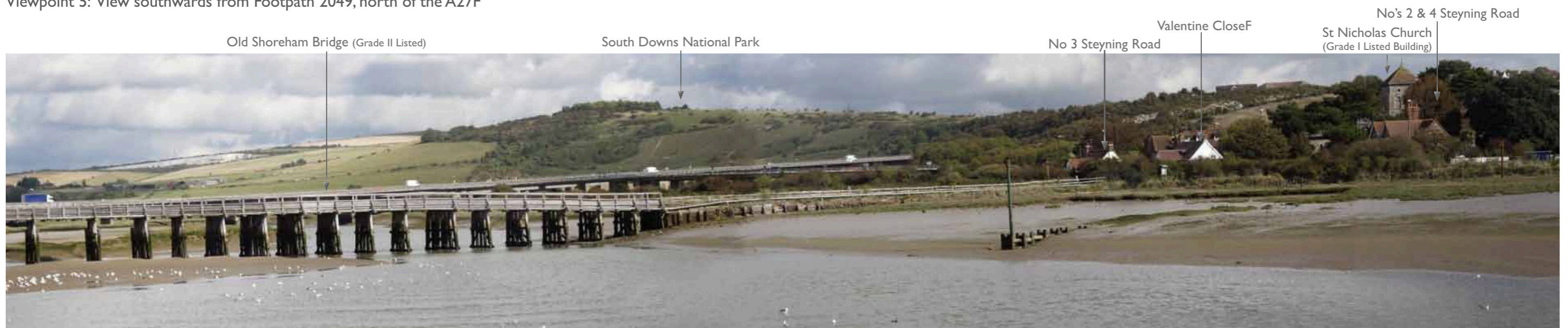

Viewpoint 6: View from Footpath 2048, east of Shoreham Airport airfield looking northwards towards Old Shoreham BridgeF



Viewpoint 7: View from the grounds of St Nicholas Church



Viewpoint 8: View from Shoreham Airport Terminal Building



Viewpoint 9: View from the car park in Lancing College



Viewpoint 10: View from Mill Hill, South Downs National Park



Viewpoint 11: View from Mill Hill Road Bridge F

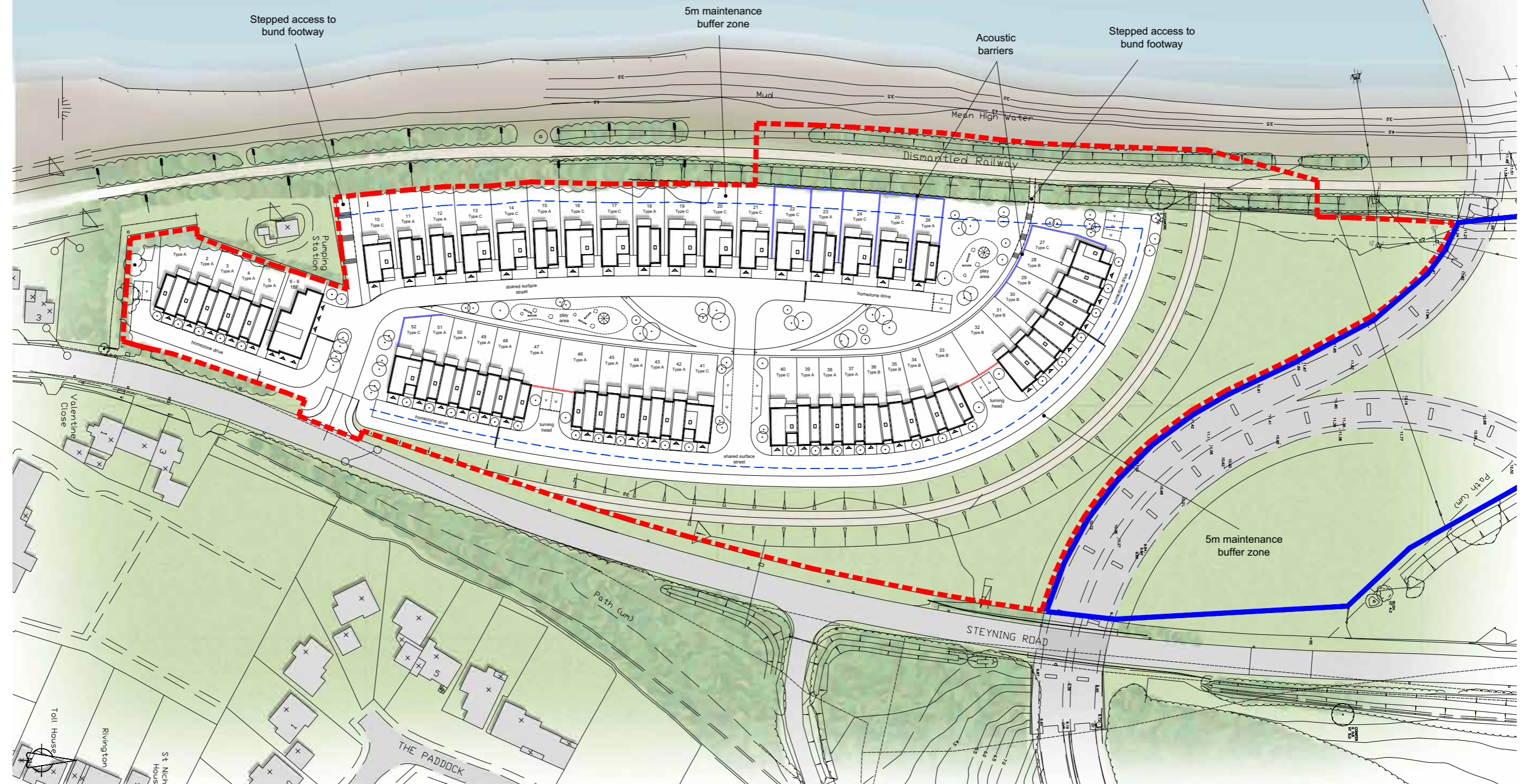

- Site Key -
- - - - - Proposed Application Boundary
  - Under Clients Ownership
  - Proposed 3.5m Acoustic Barrier
  - Proposed 2.5m Acoustic Barrier

Client's Name  
**Cobbetts Developments**

Job Title  
**Steyning Road**

Drawing Title  
**Proposed Site Layout - Draft**

Scale  
**1:500 @ A1 / 1:1000 @ A3**

Drawn	Checked	Date
LT	PF	26.10.16

Job No	Drawing No	Rev
6393	002	B

**INFORMATION**

Rev	Date	Revision Details	Dr	Ch
B	01.12.16	Layout updated to reflect acoustic information	LT	PF
A	17.11.16	Updated to comments	LT	PF

London: Unit 1, West Coale, House 3 Coale Street, London, E2 9AG  
T 020 7729 5505 E london@ecearchitecture.com

Sussex: Brooklyn Chambers, 11 Goring Road Worthing, West Sussex, BN12 4AP  
T 01903 248777 E sussex@ecearchitecture.com

Bristol: Westworks, St. Nicholas House 31-34 High Street, Bristol, BS1 2AW  
T 0117 315 8557 E bristol@eceworks.com

**ECE Architecture**  
www.ecearchitecture.com

© ECE Architecture Limited. No dimensions to be scaled from drawing except for the purposes of Planning Applications. The contractor should check all dimensions on site. It is the contractors responsibility to ensure compliance with Building Regulations.